

Explosion-protected LED ceiling- or wall-mounting light fitting

ExGLOBE e9312F SK

[Item no. : 93120 0001]



General product description

Explosion-protected LED wall- or ceiling-mounted light fitting ExGLOBE for zone 1 /21. Die-cast aluminium housing with moulded fixing points, unpainted, electrical kit made of die-cast aluminium with LED module and integrated ECG. Frosted PC cover, wire guard made of galvanised steel.

General product benefits

- robust, corrosion-resistant housing
- impact-resistant PC cover
- additional safety due to robust wire guard
- homogenous illumination due to frosted PC cover for comfortable perception of light and brilliant glare limitation
- easy mounting due to outer fixing points

Applications

Hazardous areas zone 1 (gas) and zone 21 (dust) with minimal requirements for illuminance, confined space conditions or hard-to-reach areas

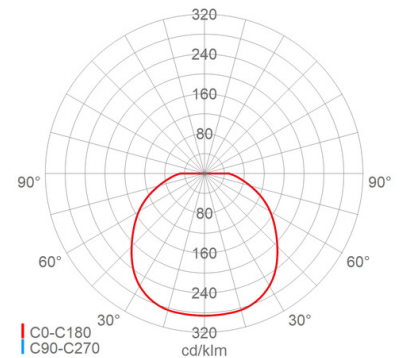
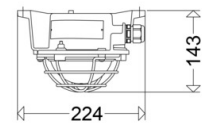
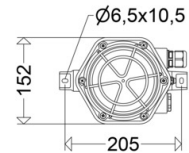

Explosion-protected LED ceiling- or wall-mounting light fitting

ExGLOBE**e9312F SK****[Item no. : 93120 0001]****Technical data****Explosion protection**

EX-Zone:	1 , 21 , 2 , 22
EX-marking gas:	II 2 G Ex eb mb IIC T4 Gb
EX-marking dust:	II 2 D Ex tb IIIC T80 °C Db
Primary ignition protection method:	eb
Temperature class:	T4
Surface temperature:	T80°C
ATEX:	IBExU20ATEX1092
IECEX:	IECEX IBE 20.0013

Features/Certificates

IP rating:	IP66
Approval marks:	CE
Energy efficiency class:	G

Dimension/Weight

Length:	224.00 mm
Width/Diameter:	152.00 mm
Height:	143.00 mm
Net weight:	1.30 kg
EAN/GTIN:	4041254342689

Key technical data

Light source:	LED
Exchangeability:	light source with control gear replaceable by qualified person
Connected load:	11 W
Luminaire luminous flux:	600 lm
Luminous efficacy:	55 lm/W
Colour temperature:	6500 K
Admissible ambient temperature T _a :	-25 °C to +40 °C
Control gear:	1 x ECG

Lighting technology

Light distribution:	rotationally symmetrical beam
---------------------	-------------------------------

Service life

Service life LED:	L70>100000 h (@ T _a max)
-------------------	-------------------------------------

Electrical connection

Rated voltage:	220 - 240 V, 0 Hz, 50/60 Hz
Terminal clamp:	Cage clamp, 3-polig, 1 - 2.5 mm ²
Max. no. (with CB B16):	130
CB B10/B13/B20:	82/106/163
CB C10/C13/C16/C20:	135/175/221/270
Cable entries:	M25 (2x), cable gland (2x), Plastic, 8 - 17 mm

Housing

Housing material:	Die-cast aluminium
-------------------	--------------------

Cover

Cover type/material:	Diffuser (PC)
Cover characteristic:	satined
Closure:	screwed (Galvanised steel)
Protective cover:	Wire guard

Mounting

Mounting method (accessories possibly needed):	Ceiling, Wall
Operating position:	downwards radiation, forwards radiation, vertical, horizontal
Mounting:	2-point

Features/Certificates

Protection class:	I
-------------------	---

Explosion-protected LED ceiling- or wall-mounting light fitting

ExGLOBE
e9312F SK
[Item no. : 93120 0001]

Optional accessories/spare parts

Item no.	Item name	Item description
93101 9000	ABD 9309F	
93101 9001	SK 930 A	spare wire guard
90117 9000	2537	cable gland M25 for Ex-Zone 1/21
90118 9000	2538	screw plug M25 for Ex-Zone 1/21