

Explosion-protected LED pole mounted light fitting

e840 06L42 PM ESSO

[Item no. : 84005 7803]

General product description

Explosion-protected LED pole mounted light fitting with central locking system for zone 1/21. Glass fibre reinforced polyester housing, clear cover made of polycarbonate with internal prisms and silicone gasket. Aluminium reflector, varnished, with encapsulated LED modules and frosted covers for glare limitation, hinged and removable. Encapsulated ECG with overvoltage, overload and short circuit protection.

General product benefits

- for application in food industry areas, in accordance with IFS/BRC/VDMA standards, applicable without restrictions in plants, that have to fulfil the HACCP Concept
- extremely robust light fitting with high material thickness of housing and cover
- comfortable central locking system for fast connection and component exchange
- innovative LED encapsulation with high transmission factor for least loss of light
- homogenous illumination due to frosted protective covers on the LED modules for comfortable perception of light and brilliant glare limitation as well as protection against mechanical and electrostatic damage
- high colour rendering index $CRI \geq 80$, according to the workplace guidelines suitable for nearly all plant locations
- sustainable, interchangeable components

Applications

Hazardous areas zone 1 (gas) and zone 21 (dust), light fitting is not suitable for use in areas with permanently high humidity and short operation time, e.g. sewage plants and rainwater retention basins, food industry, food processing factories and suppliers to the food industry that have to fulfil IFS, BRC or HACCP standards or comparably strict requirements (e.g. production of food packaging). The light fitting is not suitable for cleaning with cleaning and disinfection agents as well as for cleaning with high pressure cleaners

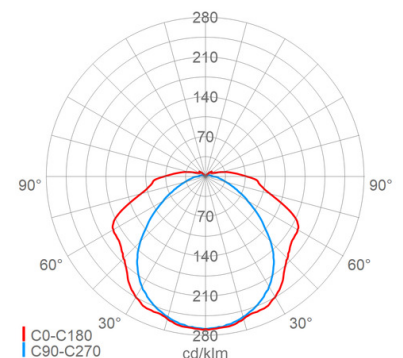
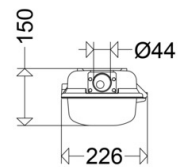
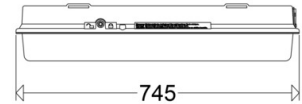

Explosion-protected LED pole mounted light fitting

e840 06L42 PM ESSO

[Item no. : 84005 7803]

Technical data**Explosion protection**

EX-Zone:	1, 21, 2, 22
EX-marking gas:	II 2 G Ex eb mb op is q IIC T4 Gb
EX-marking dust:	II 2 D Ex op is tb IIIC T80°C Db
Primary ignition protection method:	eb
Temperature class:	T4
Surface temperature:	T80°C
ATEX:	IBExU 19 ATEX 1135
IECEX:	IECEX IBE 19.0027

Key technical data

Light source:	LED
LED module standard:	Zhaga
Exchangeability:	light source with reflector and control gear replaceable by qualified person
Connected load:	28 W
Luminaire luminous flux:	4067 lm
Luminous efficacy:	145 lm/W
Colour temperature:	6500 K
Colour rendering (CRI):	≥ 80
Light colour:	865
Admissible ambient temperature T _a :	-25 °C to +55 °C
Control gear:	1 x ECG, Overload protection, Short circuit protection

Lighting technology

Light distribution:	wide beam
Photobiological safety:	RG1

Service life

Service life LED:	L80B50>100000 h (@ Ta 25°C), L90B50>85000 h (@ Ta 25°C), L80B50>100000 h (@ Ta max)
-------------------	---

Electrical connection

Rated voltage:	220 - 240 V, 0 Hz, 50/60 Hz
Terminal clamp:	Cage clamp, 3-polig, 1 - 4 mm ²
Max. no. (with CB B16):	19
CB B10/B13/B20:	12/16/24
CB C10/C13/C16/C20:	19/25/32/39
Cable entries:	M20 (1x), cable gland (1x), Plastic, 8 - 13 mm

Housing

Housing material:	Glass fibre reinforced polyester
Colour:	grey

Cover

Cover type/material:	Diffuser (PC)
Cover characteristic:	clear with inner-prisms

Cover

Closure:	Central locking (hex socket 13mm) (Plastic)
----------	---

Mounting

Mounting method (accessories possibly needed):	Side-entry mounting
Operating position:	downwards radiation
Mounting:	2-point
Side-entry mounting:	Ø 42mm x 150mm

Features/Certificates

Protection class:	I
IP rating:	IP66
IK rating:	IK10
Approval marks:	CE
Energy efficiency class:	C

Dimension/Weight

Length:	745.00 mm
Width/Diameter:	226.00 mm
Height:	150.00 mm
Net weight:	7.90 kg
EAN/GTIN:	4041254341347

Explosion-protected LED pole mounted light fitting

e840 06L42 PM ESSO

[Item no. : 84005 7803]

Optional accessories/spare parts

Item no.	Item name	Item description
90117 9006	2537 G	cable gland M25 with locknut for Ex-Zone 1/21
90118 9006	2538 G	screw plug M25 with locknut for Ex-Zone 1/21
90119 9001	2539 G	cable gland M25 with blanking plug and locknut for Ex-Zone 1/21
90259 9000	KS25 G EX	breathing gland M25 for Ex-Zone 1/21
90001 0002	H8V P	2 suspension eyes with bolt M8, stainless steel
90000 0002	DS 15A P	1 pair of brackets for direct ceiling mounting, hot galvanized steel with 2 screws M8
90032 0002	DS 15AV P	1 pair of brackets for direct ceiling mounting, stainless steel with 2 screws M8
90000 0011	DW 84 AA P	1 pair of brackets for direct ceiling mounting, stainless steel with 2 screws M8 for compensating different mounting distances
90037 0004	RO84 112 A P	Pipe clamp (1 pair) stainless steel material 1.4571 1 1/2" with support and 4 M8 screws also for pole mounting
90038 0004	RO84 2 A P	Pipe clamp (1 pair) stainless steel material 1.4571 1 2" with support and 4 M8 screws also for pole mounting
26000 0008	WW 26 L P	1 pair of brackets for wall mounting, hot galvanized steel 90° with 2 M8 screws long version
26000 0002	WW 26/30 P	1 pair of brackets for wall mounting, hot galvanized steel 30° with 2 M8 screws
26000 0003	WW 26/45 P	1 pair of brackets for wall mounting, hot galvanized steel 45° with 2 M8 screws