

## Explosion-protected LED pole mounted light fitting

### e840 06L22 PM ESSO

[ Item no. : 84005 7801 ]

#### General product description

Explosion-protected LED pole mounted light fitting with central locking system for zone 1/21. Glass fibre reinforced polyester housing, clear cover made of polycarbonate with internal prisms and silicone gasket. Aluminium reflector, varnished, with encapsulated LED modules and frosted covers for glare limitation, hinged and removable. Encapsulated ECG with overvoltage, overload and short circuit protection.

#### Applications

Hazardous areas zone 1 (gas) and zone 21 (dust), light fitting is not suitable for use in areas with permanently high humidity and short operation time, e.g. sewage plants and rainwater retention basins, food industry, food processing factories and suppliers to the food industry that have to fulfil IFS, BRC or HACCP standards or comparably strict requirements (e.g. production of food packaging). The light fitting is not suitable for cleaning with cleaning and disinfection agents as well as for cleaning with high pressure cleaners

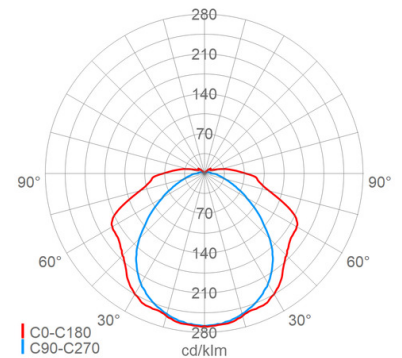
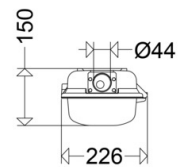
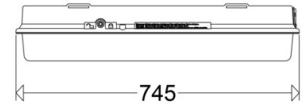

## Explosion-protected LED pole mounted light fitting

**e840 06L22 PM ESSO****[ Item no. : 84005 7801 ]****Technical data****Explosion protection**

EX-Zone:	1, 21, 2, 22
EX-marking gas:	II 2 G Ex eb mb op is q IIC T4 Gb
EX-marking dust:	II 2 D Ex op is tb IIC T80°C Db
Primary ignition protection method:	eb
Temperature class:	T4
Surface temperature:	T80°C
ATEX:	IBExU 19 ATEX 1135
IECEX:	IECEX IBE 19.0027

**Key technical data**

Light source:	LED
LED module standard:	Zhaga
Exchangeability:	light source with reflector and control gear replaceable by qualified person
Connected load:	16 W
Luminaire luminous flux:	2054 lm
Luminous efficacy:	128 lm/W
Colour temperature:	6500 K
Colour rendering (CRI):	≥ 80
Light colour:	865
Admissible ambient temperature T <sub>a</sub> :	-25 °C to +55 °C
Control gear:	1 x ECG, Overload protection, Short circuit protection

**Lighting technology**

Light distribution:	wide beam
Photobiological safety:	RG1

**Service life**

Service life LED:	L80B50>100000 h (@ Ta 25°C), L90B50>85000 h (@ Ta 25°C), L80B50>100000 h (@ Ta max)
-------------------	---

**Electrical connection**

Rated voltage:	220 - 240 V, 0 Hz, 50/60 Hz
Terminal clamp:	Cage clamp, 3-polig, 1 - 4 mm²
Max. no. (with CB B16):	19
CB B10/B13/B20:	12/16/24
CB C10/C13/C16/C20:	19/25/32/39
Cable entries:	M20 (1x), cable gland (1x), Plastic, 8 - 13 mm

**Housing**

Housing material:	Glass fibre reinforced polyester
Colour:	grey

**Cover**

Cover type/material:	Diffuser (PC)
Cover characteristic:	clear with inner-prisms

**Cover**

Closure:	Central locking (hex socket 13mm) (Plastic)
----------	---

**Mounting**

Mounting method (accessories possibly needed):	Side-entry mounting
Operating position:	downwards radiation
Mounting:	2-point
Side-entry mounting:	Ø 42mm x 150mm

**Features/Certificates**

Protection class:	I
IP rating:	IP66
IK rating:	IK10
Approval marks:	CE
Energy efficiency class:	C

**Dimension/Weight**

Length:	745.00 mm
Width/Diameter:	226.00 mm
Height:	150.00 mm
Net weight:	7.90 kg
EAN/GTIN:	4041254305165

## Explosion-protected LED pole mounted light fitting

**e840 06L22 PM ESSO****[ Item no. : 84005 7801 ]****Optional accessories/spare parts**

Item no.	Item name	Item description
90117 9006	2537 G	cable gland M25 with locknut for Ex-Zone 1/21
90118 9006	2538 G	screw plug M25 with locknut for Ex-Zone 1/21
90119 9001	2539 G	cable gland M25 with blanking plug and locknut for Ex-Zone 1/21
90259 9000	KS25 G EX	breathing gland M25 for Ex-Zone 1/21
90001 0002	H8V P	2 suspension eyes with bolt M8, stainless steel
90000 0002	DS 15A P	ceiling rail (1 pair) galvanised steel with 2 M8 screws
90032 0002	DS 15AV P	ceiling rail (1 pair) stainless steel 1.4571 with 2 M8 screws
90000 0011	DW 84 AA P	ceiling mounting (1 pair) stainless steel 1.4301 with 2 M8 screws to equalise the different mounting distances
90037 0004	RO84 112 A P	Pipe clamp (1 pair) stainless steel material 1.4571 1 1/2" with support and 4 M8 screws also for pole mounting
90038 0004	RO84 2 A P	Pipe clamp (1 pair) stainless steel material 1.4571 1 2" with support and 4 M8 screws also for pole mounting
26000 0008	WW 26 L P	wall mounting (1 pair) galvanised steel 55° with 2 M8 screws long version
26000 0002	WW 26/30 P	wall mounting (1 pair) galvanised steel 30° with 2 M8 screws
26000 0003	WW 26/45 P	wall mounting (1 pair) galvanised steel 45° with 2 M8 screws