

NEW**BELLA****Pendant LED Light Fittings with variable setting of the luminous flux****Series 564/565... G2 VARIO****Applications:**

Renewal of villages and historic city centres, low traffic areas, pedestrian areas, promenades, public parks.

Design:

Housing: Aluminium sheet, powder coated in DB 702 (mica-iron paint, grey).

Cover: Diffuser PMMA pearled

Electro kit: ECG and LED wired ready for

connection, cable retainer for connection cable in housing.

Light distribution: Asymmetrical wide beam or symmetrical circular beam (R).

Switch for setting the luminous flux of the luminaire.

Mounting: To pole top sections with internal thread 3/4" (see accessories / spare parts).

**Electrical design:**

LED module: 4,000K or 3,000K, $R_a > 70$, service life $L_{90} > 100,000h$, Zhaga compliant

ECG: 220-240V, 50-60Hz, Surge voltage resistance 10kV, overload and short circuit protection.

Light control:

On request, the luminaires are also available with the following configurations:

Output reduction with control phase (LR): For reducing the luminous flux to 50% at times of low traffic density. Control phase (LST) required. Switching via control phase (LST = 230V: 100%; LST = 0V: 50%). Alternative dimming levels possible.

Output reduction without control phase (LA): Autarkic dimming. Reduced operation 50% between 22:00 and 4:00h CET or 23:00 and 5:00h CEST, also available with deviating times and with alternative dimming steps.

Digital dimming with DALI interface (DIMD)

Constant luminous flux function (CL): Luminous flux is kept on a constant level over the entire service life of the LED-modules.

Options:

- 2,200K, light colour 722 networks respectively
- (approx. 15% lower luminous flux) - additional overvoltage protection (OP) in SKI
- 1,800K, light colour 518 „Amber“ (approx. 45% lower luminous flux)
- protection class I (SKI)
- inrush current limiter (ESSB)
- optics for cycle track (RWX)
- seawater-resistant version (SWP)
- for connection to group or central battery systems (ZB) or emergency lighting
- special painting in RAL colours (SL)
- with backside light shielding (HA)

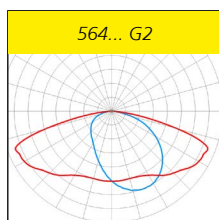
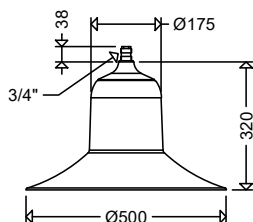
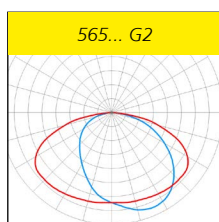
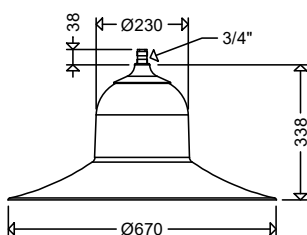
Series 564... G2**Series 565... G2****Product highlights:**

- optimal light distribution due to highly efficient lens optics with direct beam
- good glare limitation due to low-lying pearled cover
- homogeneous illumination due to Multi-Layer technology, i.e. every individual LED illuminates the total area, the light curves of the individual LEDs are overlapping.
- quick maintenance and change of components due to tool-free exchangeable gear-tray system (electrical block)
- eco-friendly, no light emission into the upper half space, $ULOR=0$
- all versions dimmable to 10% with color temperature up to max. 3,000K fulfill the Dark Sky requirements
- sustainable, control gear and LED-module replaceable by qualified personnel on-site
- future proof by using standardized LED-modules (Zhaga)

! Properties, limitations and details for controlling LED-light fittings:

■ See "Technical Supplement"

All data are correct at the time of printing. Actual technical data can be found under www.schuch.de.



Article No.	Type	Connected load [W]	Luminous flux [lm] ¹⁾	Luminous efficacy [lm/W] (up to)	Substitute for ca. *	Weight [kg] (without packing material)
-------------	------	--------------------	----------------------------------	----------------------------------	----------------------	--

564... G2 VARIO

IP54

Wind load area A = 0,09m²

The luminous flux is variably adjustable. The Connected load will change depending on the setting of the luminous flux. In the table you will find examples of settings with reference to common conventional versions. Intermediate values are also possible. Setting table on request.

colour temperature 4.000K (light colour 740)

56401 0001	564 L25 G2 VARIO	5 - 18	690 - 2.840	168	HST 35 - HST 50	2,8
56401 0003	564 L25R G2 VARIO	5 - 18	690 - 2.840	168	HST 35 - HST 50	2,8
56401 0002	564 L50 G2 VARIO	9 - 35	1.390 - 5.580	178	HST 35 - 2 x HST 70	2,8
56401 0004	564 L50R G2 VARIO	9 - 35	1.390 - 5.580	178	HST 35 - 2 x HST 70	2,8

colour temperature 3.000K (light colour 730)

56401 0005	564 L25 G2 VARIO 730	5 - 18	660 - 2.700	159	HST 35 - HST 50	2,8
56401 0007	564 L25R G2 VARIO 730	5 - 18	660 - 2.700	159	HST 35 - HST 50	2,8
56401 0006	564 L50 G2 VARIO 730	9 - 35	1.320 - 5.300	169	HST 35 - 2 x HST 70	2,8
56401 0008	564 L50R G2 VARIO 730	9 - 35	1.320 - 5.300	169	HST 35 - 2 x HST 70	2,8

IP54

Wind load area A = 0,12m²

565... VARIO G2

colour temperature 4.000K (light colour 740)

56501 0001	565 L50 G2 VARIO	9 - 35	1.360 - 5.580	176	HST 35 - 2 x HST 70	4,4
56501 0003	565 L50R G2 VARIO	9 - 35	1.360 - 5.580	176	HST 35 - 2 x HST 70	4,4
56501 0002	565 L100 G2 VARIO	16 - 70	2.760 - 11.150	178	HST 50 - HSE 150	4,5
56501 0004	565 L100R G2 VARIO	16 - 70	2.760 - 11.150	178	HST 50 - HSE 150	4,5

colour temperature 3.000K (light colour 730)

56501 0005	565 L50 G2 VARIO 730	9 - 35	1.290 - 5.300	167	HST 35 - 2 x HST 70	4,4
56501 0007	565 L50R G2 VARIO 730	9 - 35	1.290 - 5.300	167	HST 35 - 2 x HST 70	4,4
56501 0006	565 L100 G2 VARIO 730	16 - 70	2.620 - 10.590	169	HST 50 - HSE 150	4,5
56501 0008	565 L100R G2 VARIO 730	16 - 70	2.620 - 10.590	169	HST 50 - HSE 150	4,5

Factory setting L25: 18 W; replaces approx. HST 50

Factory setting L100: 54 W; replaces approx. HME 250

Factory setting L50: 18 W; replaces approx. HME 125, HST 70

* The given information is for rough orientation only. In each individual case a lighting calculation is necessary.

1) possible setting range

Round arch pole-top adapter for pendant lights with upper thread 3/4"

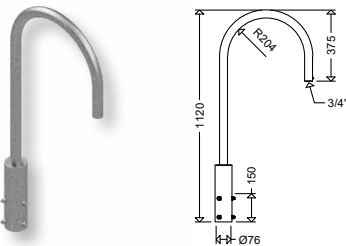

Article no.	Type	Description	Weight
61999 0001	619/1	for 1 fitting	8,8 kg

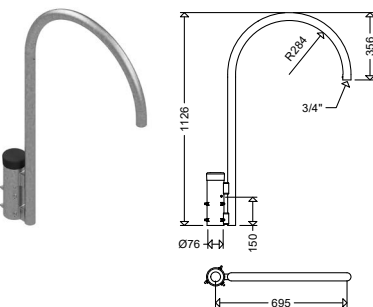

72299 0001	722/1	for 1 fitting	8,2 kg
72299 0002	722/2	for 2 fitting	14,0 kg
72299 0003	722/3	for 3 fittings	19,9 kg
72299 0004	722/4	for 4 fittings	25,7 kg

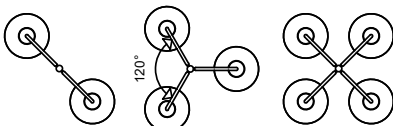

Tops also available painted to match luminaire color (SL).

Also available with output reduction (LR / LA) or constant luminous flux function (CL) as well as combinations of these functions (CL LR / CL LA).

Accessories / Spare Parts

Article no.	Type	
56410 0001	ABD 564 G2 P	cover, diffuser PMMA pearled, for 564... G2
56510 0001	ABD 565 G2 P	cover, diffuser PMMA pearled, for 565... G2