

**NEW**

## BELLA Pendant LED Light Fittings Series 564/565... G2



### Applications:

Renewal of villages and historic city centres, low traffic areas, pedestrian areas, promenades, public parks.

### Design:

**Housing:** Aluminium sheet, powder coated in DB 702 (mica-iron paint, grey).  
**Cover:** Diffuser PMMA pearled

**Electro kit:** ECG and LED wired ready for connection, cable retainer for connection cable in housing.

**Light distribution:** Asymmetrical wide beam or symmetrical circular beam (R).

**Mounting:** To pole top sections with internal thread 3/4" (see accessories / spare parts).

### Electrical design:

**LED module:** 4,000K or 3,000K,  $R_a > 70$ , service life  $L_{90} > 100,000h$ , Zhaga compliant

**ECG:** 220-240V, 50-60Hz, Surge voltage resistance 10kV, overload and short circuit protection.

### Light control:

On request, the luminaires are also available with the following configurations:

**Output reduction with control phase (LR):** For reducing the luminous flux to 50% at times of low traffic density. Control phase (LST) required. Switching via control phase (LST = 230V: 100%; LST = 0V: 50%). Alternative dimming levels possible.

**Output reduction without control phase (LA):** Autarkic dimming. Reduced operation 50% between 22:00 and 4:00h CET or 23:00 and 5:00h CEST, also available with deviating times and with alternative dimming steps.

**Digital dimming with DALI interface (DIMD)**

**Constant luminous flux function (CL):** Luminous flux is kept on a constant level over the entire service life of the LED-modules.

### Options:

- 2,200K, light colour 722 (approx. 15% lower luminous flux)
- 1,800K, light colour 518 „Amber“ (approx. 45% lower luminous flux)
- protection class I (SKI)
- optics for cycle track (RWX)
- for connection to group or central bat-

tery systems (ZB) or emergency lighting networks respectively

- additional overvoltage protection (OP) in SKI
- inrush current limiter (ESSB)
- seawater-resistant version (SWP)
- special painting in RAL colours (SL)
- with backside light shielding (HA)

### Series 564... G2

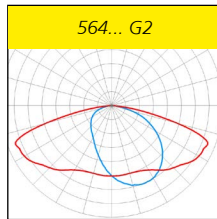
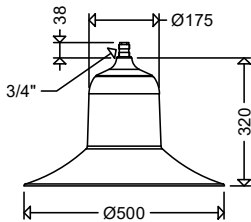

### Series 565... G2

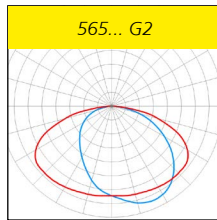
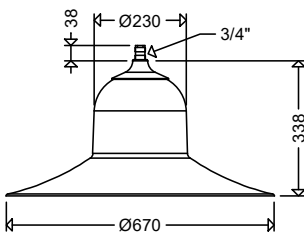

### Product highlights:

- optimal light distribution due to highly efficient lens optics with direct beam
- good glare limitation due to low-lying pearled cover
- homogeneous illumination due to Multi-Layer technology, i.e. every individual LED illuminates the total area, the light curves of the individual LEDs are overlapping.
- quick maintenance and change of components due to tool-free exchangeable gear-tray system (electrical block)
- eco-friendly, no light emission into the upper half space,  $ULOR=0$
- all versions dimmable to 10% with color temperature up to max. 3,000K fulfill the Dark Sky requirements
- sustainable, control gear and LED-module replaceable by qualified personnel on-site
- future proof by using standardized LED-modules (Zhaga)

! Properties, limitations and details for controlling LED-light fittings:

■ See "Technical Supplement"

All data are correct at the time of printing. Actual technical data can be found under [www.schuch.de](http://www.schuch.de).



Outdoor  
Light Fittings

Article No.	Type	Connected load [W]	Luminous flux [lm]	Luminous efficacy [lm/W]	Weight [kg] (without packing material)
-------------	------	--------------------	--------------------	--------------------------	--

## 564... G2

IP54  Wind load area A = 0,09m<sup>2</sup>

All light fittings also available with connected cable (H07RN-F or NYM) in the required length.

### colour temperature 4.000K (light colour 740)

56400 0001	564 0801 G2	9	1.510	168	2,8
56400 0002	564 0802 G2	13	2.100	162	2,8
56400 0003	564 0803 G2	18	2.840	158	2,8
56400 0007	564 0801R G2	9	1.510	168	2,8
56400 0008	564 0802R G2	13	2.100	162	2,8
56400 0009	564 0803R G2	18	2.840	158	2,8
56400 0004	564 1601 G2	17	3.000	176	2,8
56400 0005	564 1602 G2	25	4.170	167	2,8
56400 0006	564 1603 G2	35	5.580	159	2,8
56400 0010	564 1601R G2	17	3.000	176	2,8
56400 0011	564 1602R G2	25	4.170	167	2,8
56400 0012	564 1603R G2	35	5.580	159	2,8

### colour temperature 3.000K (light colour 730)

56400 0013	564 0801 G2 730	9	1.430	159	2,8
56400 0014	564 0802 G2 730	13	2.000	154	2,8
56400 0015	564 0803 G2 730	18	2.700	150	2,8
56400 0019	564 0801R G2 730	9	1.430	159	2,8
56400 0020	564 0802R G2 730	13	2.000	154	2,8
56400 0021	564 0803R G2 730	18	2.700	150	2,8
56400 0016	564 1601 G2 730	17	2.850	168	2,8
56400 0017	564 1602 G2 730	25	3.960	158	2,8
56400 0018	564 1603 G2 730	35	5.300	151	2,8
56400 0022	564 1601R G2 730	17	2.850	168	2,8
56400 0023	564 1602R G2 730	25	3.960	158	2,8
56400 0024	564 1603R G2 730	35	5.300	151	2,8

### Round arch pole-top adapter for pendant lights with upper thread 3/4"

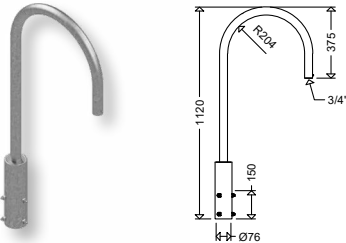

Article no.	Type	Description	Weight
61999 0001	619/1	for 1 fitting	8,8 kg

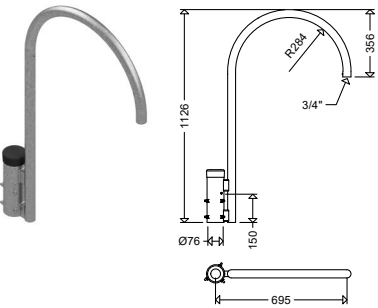

72299 0001	722/1	for 1 fitting	8,2 kg
72299 0002	722/2	for 2 fitting	14,0 kg
72299 0003	722/3	for 3 fittings	19,9 kg
72299 0004	722/4	for 4 fittings	25,7 kg

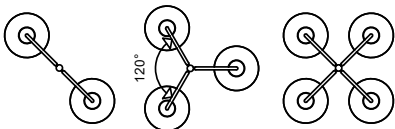

Tops also available painted to match luminaire color (SL).

## 565... G2

IP54  Wind load area A = 0,12m<sup>2</sup>

### colour temperature 4.000K (light colour 740)

56500 0001	565 1601 G2	17	2.960	174	4,4
56500 0002	565 1602 G2	25	4.130	165	4,4
56500 0003	565 1603 G2	35	5.580	159	4,4
56500 0007	565 1601R G2	17	2.960	174	4,4
56500 0008	565 1602R G2	25	4.130	165	4,4
56500 0009	565 1603R G2	35	5.580	159	4,4
56500 0004	565 3201 G2	34	5.990	176	4,5
56500 0005	565 3202 G2	50	8.300	166	4,5
56500 0006	565 3203 G2	70	11.150	159	4,5
56500 0010	565 3201R G2	34	5.990	176	4,5
56500 0011	565 3202R G2	50	8.300	166	4,5
56500 0012	565 3203R G2	70	11.150	159	4,5

### colour temperature 3.000K (light colour 730)

56500 0013	565 1601 G2 730	17	2.810	165	4,4
56500 0014	565 1602 G2 730	25	3.920	157	4,4
56500 0015	565 1603 G2 730	35	5.300	151	4,4
56500 0019	565 1601R G2 730	17	2.810	165	4,4
56500 0020	565 1602R G2 730	25	3.920	157	4,4
56500 0021	565 1603R G2 730	35	5.300	151	4,4
56500 0016	565 3201 G2 730	34	5.690	167	4,5
56500 0017	565 3202 G2 730	50	7.890	158	4,5
56500 0018	565 3203 G2 730	70	10.590	151	4,5
56500 0022	565 3201R G2 730	34	5.690	167	4,5
56500 0023	565 3202R G2 730	50	7.890	158	4,5
56500 0024	565 3203R G2 730	70	10.590	151	4,5

Also available with output reduction (LR / LA) or constant luminous flux function (CL) as well as combinations of these functions (CL LR / CL LA).

## Accessories / Spare Parts

Article no.	Type	
56410 0001	ABD 564 G2 P	cover, diffuser PMMA pearled, for 564... G2
56510 0001	ABD 565 G2 P	cover, diffuser PMMA pearled, for 565... G2